

2-Leg Electric Base SX, SE Components Required:

1. Top Plate x2
2. Leg x2
3. Foot x2
4. Crossbar x1
5. Control Box x1
6. Control Switch x1
7. 120v Power Cord x1
8. Network Cable x2
9. Hardware Bag x1

*** INCLUDES EXTRA HARDWARE FOR DIFFERENT SURFACE TYPES. INCLUDES 8 EXTRA R011057(M6X16) SCREWS FOR THREADED INSERTS, AND 15 EXTRA R011528 (5X25mm) WOOD SCREWS FOR NON-THREADED INSERT WORKSURFACE ASSEMBLY.***

Assembly Steps:

1. Attach top plate to each leg(2) using four m6x8 screws(A).
2. Attach foot(3) to each leg(2) using four m6x16 screws(B) on each leg.
3. Attach two glides(D) to each foot(3).
4. Attach adjustable crossbar(4) end sections to the back of each leg(2) with two m6x8(A) machine screws.

4a. NOTE: Depending on frame model, supplied horizontal crossbar may be fixed length without adjustment feature. Skip to step 6 on page 2 of 2.

5. Line up mount holes in top plate(1) with corresponding pilot holes on the underside of the table top. Attach center section of adjustable crossbar to end sections with four m6x8(B) machine screws and four lock nuts(C) along aligned hole pattern in adjacent crossbar sections.



A x 16 (m6x8)
R011073



B X 16 (m6X16)
R011057



C x 4 (nut)
R011172

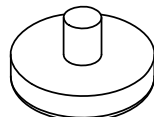

D x 4
RM-175

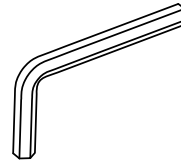

HEX WRENCH
R011921

Note: Additional hardware shown on page 2 of 2
Tools required: Drill driver, PHILLIPS bit PH1 and PH2. Hex key 4mm.

2-Leg Electric Base SX, SE

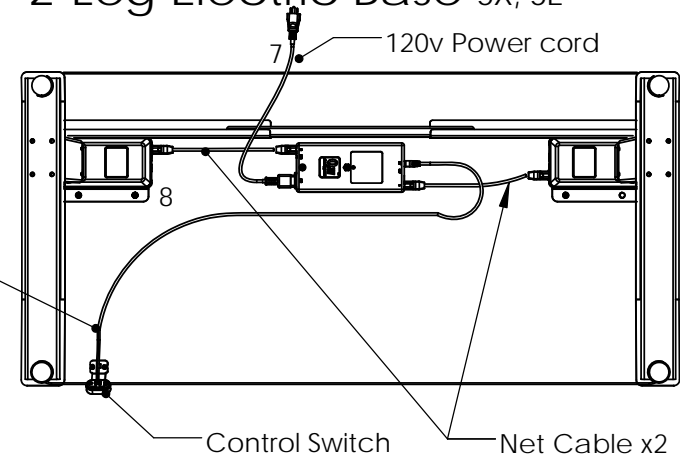
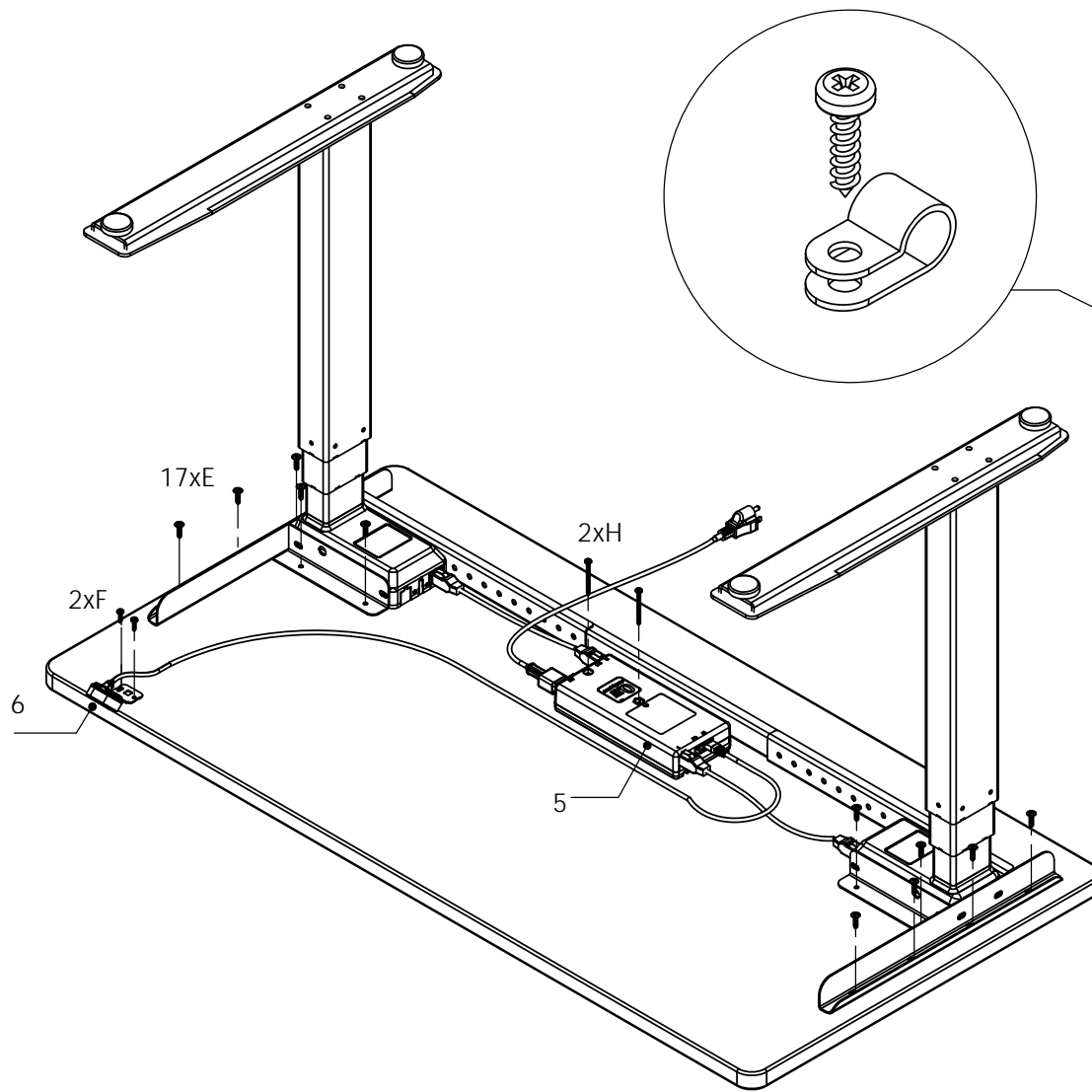

6. Attach assembled base to work surface using seventeen 5x25mm wood screws(E), or eight m6X16 machine screws(B) and nine 5x25mm wood screws(E) depending if surface has threaded inserts or pilot holes.

7. Attach control box(5) to underside of worksurface using two 4x50mm screws(H).

8. Connect a network cable(8) to the control box(5) and then to each leg(2).

9. Attach control switch cable(6) to underside of worksurface using two 4x16m screws(F).

10. Connect control switch cable(6) and power cable(7) to control box(5), and then power cord(7) to 120v power outlet.

11. Perform initial reset by pushing the down-button until the table stops. Push the down-button again and "hold" until the legs stop moving.

11. Troubleshooting: Make sure that all cables are correctly connected to the control box, legs, control switch, and power source. Perform a new reset and make sure the procedure has completely finished before normal operation.



E x 23 (5x25mm)
R011528



F x 16 (4x16mm)
R011500



G x 10 (Wire clip)
RO10230

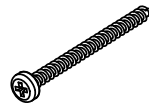

H x 2 (4x50mm)
R011501